

Dustless®

HEPA WET+DRY PRO OWNERS MANUAL

D1618



Dustless®
TECHNOLOGIES

LIVE CUSTOMER SUPPORT & SERVICE:
1.800.568.3949 Toll-free in the U.S.
dustlesstools.com

IMPORTANT SAFETY INSTRUCTIONS

IMPORTANTES MEDIDAS DE SEGURIDAD IMPORTANTE PARA SU SEGURIDAD

SAVE THESE INSTRUCTIONS CONSERVEZ CES INSTRUCTIONS GUARDAR ESTAS INSTRUCCIONES

NOTE: The reading and understanding of the Owner's Manual is imperative prior to operating this machine. If you or your operator(s) cannot read English, have this manual explained fully before attempting to operate this machine. Si Ud. o sus operadores no pueden leer el inglés, el contenido completo de este manual debe ser explicado antes de intentar operación de esta máquina.

Note: Drawings and pictures are for reference only and given only as a guide. This appliance is intended for household and commercial use. When using an electrical appliance, basic precautions should always be followed, including the following:

TABLE OF CONTENTS

SECTION	PAGE
Warning	1
Electrical Safety	1
Double-Insulated Cord Instructions	1
Personal Safety	2
Tool Use and Care	2
Specific Safety Rules	2
In the Box	3
Setup	3
Usage	4
Maintenance	6
Troubleshooting and FAQs	7
Warranty	7

WARNING

WARNING: To reduce the risk of fire, electric shock, or injury, do not expose to rain. Store indoors.

DANGER: Never operate this unit when flammable materials or vapors are present. Sparks from static electricity or the motors may ignite dust or fumes.

WARNING: Commercial users must be trained, qualified and certified in the collection of hazardous materials such as lead, asbestos, mold, silica or other hazardous material prior to collecting it in the vacuum.

WARNING: Removal and collection of hazardous materials such as lead, asbestos, mold, and silica requires specialized training. Seek specialized training by a certifying body before performing these tasks, or procure the services of a licensed and trained commercial professional in the area of hazardous material. Use vacuum only as described in this manual. Use only manufacturer's recommended attachments.

Do not put any object into openings. Do not use with any opening blocked; keep free of dust, lint, hair, and anything that may reduce air flow.

ELECTRICAL SAFETY

Electrical components are not user serviceable. Refer all service to a qualified repair technician.

Do not handle plug or operate vacuum with wet hands.

Connect to a properly grounded outlet. See grounding instructions.

Do not leave appliance when plugged in. Unplug from outlet when not in use and before servicing.

DOUBLE-INSULATED CORD INSTRUCTIONS

WARNING: This appliance is provided with double insulation. Use only identical replacement parts. See instructions for Servicing of Double-Insulated Appliances. To reduce the risk of electrical shock, this vacuum cleaner has a polarized double-insulated plug (one blade is wider than the other). A double-insulated appliance is marked with one or more of the following: the words "DOUBLE INSULATION" or "DOUBLE INSULATED" or the double-insulation symbol (a square within a square). □

This plug will fit in a polarized outlet only one way. If the plug does not fit fully in the outlet, reverse the plug. If it still does not fit, contact a qualified electrician to install the proper outlet. Do not change plug in any way. In a double-insulated appliance, two systems of insulation are provided instead of grounding.

No grounding means is provided on a double-insulated appliance, nor should a means for grounding be added to the appliance. Use only identical replacement parts. Servicing a double-insulated appliance requires extreme care and knowledge of the system and should be done only by qualified service personnel. Replacement parts for a double-insulated appliance must be identical to the parts they replace.

PERSONAL SAFETY

Special **NOTE:** The vacuum's motors are equipped with thermal "overheat" protection. If the motors run too hot then they will shut down. You must wait for motor to cool in order to re-start vacuum. Cleaning the filter will help prevent a repeat of this condition.

Do not allow to be used as a toy. Pay close attention when used by or near children.

Do not change filters, clean the unit, or empty the barrel until the plug has been disconnected from the electrical outlet.

Use special care when emptying heavily loaded barrels.

Keep hair, loose clothing, fingers and all parts of body away from openings and moving parts. There is a risk of injury through getting stuck or being drawn into moving machinery.

Use extra care when working on stairs.

Injury to the eyes and/or body can occur if protective clothing and/or equipment is not worn. Always wear safety goggles, protective clothing, hearing protection, and a dust mask. Exposure to high noise levels can cause hearing loss or impairment. Wear OSHA-approved hearing protection.

TOOL USE AND CARE

Always check the filters before each use. Do not use without a dust collection bag and filters in place.

Do not use with damaged cord or plug.

If appliance is not working as it should, has been dropped, damaged, left outdoors, or dropped into water, return it to a service center.

Do not pull or carry by the cord, use cord as a handle, close a door on cord, or pull cord around sharp edges or corners. Do not run vacuum over cord. Keep cord away from heated surfaces.

Do not unplug by pulling on cord. To unplug, grasp the plug, not the cord.

Turn off all controls before unplugging.

Take notice of all safety and hazard notices on the vacuum.

All safety and hazard notices on the vacuum must be kept complete and legible.

Changes, add-ons, or conversions of the vacuum which might have an influence to the safety of the vacuum must not be undertaken without the permission of the manufacturer. This applies in particular to the fitting and adjustment of safety devices and to welding on major and load-bearing parts.

In the event of operational malfunction the vacuum must be shut down immediately. The malfunction must be rectified before starting the vacuum again.

The dust bin must be emptied before transportation.

Should dust begin to blow out of the vacuum, it must be shut down, cleaned (including the motor housing) and the problem fixed before returning to service. Failure to do so could put dangerous dust in the air and will void the warranty.

SPECIFIC SAFETY RULES

Never vacuum up the following materials: explosive or combustible gases, liquids and dust particles (reactive dust particles), reactive metal dust particles (such as aluminum, magnesium, zinc) in combination with highly alkaline or acidic detergents, undiluted and strong acids and alkalis or organic solvents such as petrol, paint thinners, acetone, heating oil and similar products.

Do not attempt to vacuum hot or warm ashes. Maximum temperature of ashes should not be warmer than 102 degrees Fahrenheit / 40 degrees Celsius.

Do not pick up any objects that are burning or smoking, such as cigarettes, or matches.

Do not use your vacuum cleaner as a sprayer of flammable liquids such as oil base paints, lacquers, household cleaners, etc.

If foam or liquid escapes from the machine, switch off immediately.

The vacuum cleaner should not be used as a water pump. The vacuum cleaner is intended for vacuuming air and water mixtures.

CAUTION: The machine is for indoor use only. Do not operate the vacuum cleaner in the rain.

Wear protection mask, when tank is emptied for fine dust of all kinds.

Dispose of the dust so that you meet the requirements of local regulations.

NOTE: A static shock may occur if the environment is too dry. This will not affect the use of the vacuum cleaner. To eliminate shock, add humidity to the air with a console or a humidifier.

WARNING: To avoid personal injury or further damage to the vacuum, if any of the motor housing parts should become detached or broken, exposing the motor or any other electrical components, discontinue operation immediately. Repairs should be made before reusing the vacuum.

IN THE BOX

1. Tank
2. Head
3. Hose and cord storage hook
4. Clamp
5. Drain outlet
6. Suction inlet
7. Blow regulation
8. Blow outlet
9. Control panel
10. Filter cleaning button
11. Power cord
12. Accessory storage holders
13. Tube storage holders

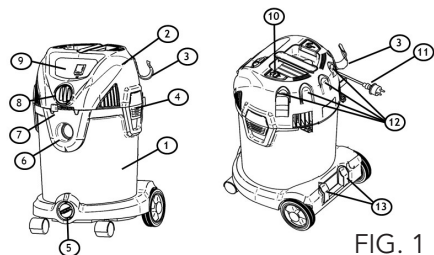

FIG. 1

- A. Crevice Nozzle
- B. Floor nozzle (dry pickup)
- C. Squeegee insert (wet pickup)
- D. Micro Pre-filter bag
- E. Hose
- F. Chrome Wands
- G. Round Brush
- H. Wet Screen Filter

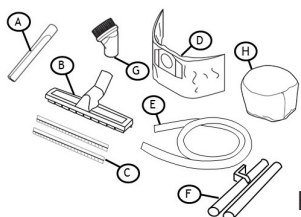

FIG. 2

Some of the accessories in FIG 2 are packed inside the tank. If parts are missing, please contact our Customer Service Department at 800.568.3949.

- I. Motor Head
- J. Filter Cage and Float
- K. HEPA Filter
- L. Filter Support Plate
- M. Filter Lock

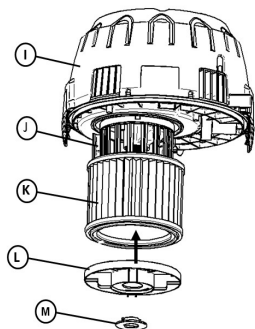

FIG. 3

SETUP

1. Remove motor head by opening clamps (A), remove the motor head (B), and remove contents (C).
2. Remove contents of barrel.

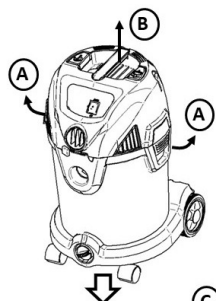

FIG. 4

3. Install hose and cord hooks over mounting points on the motor head.

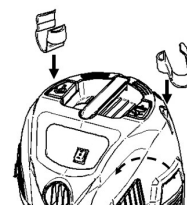

FIG. 5

4. Slide the large end of the hose into the port. Slide desired attachments on to the other end of the hose.

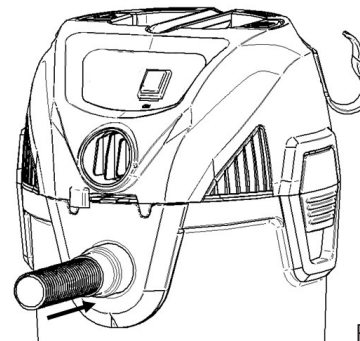

FIG. 6

5. Floor tool comes with brushes installed. To change to the squeegee for wet pick-up, pry the brush out with a screwdriver by releasing the tabs.
6. Press squeegee blades into the slot.

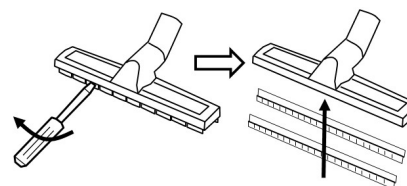

FIG. 7

FILTER BAG INSTALLATION

1. Place the collar with the rubber gasket (A) securely over the intake port on the inside of the barrel (B).
2. Reach inside the port and with your fingers press cardboard tight and secure around port.

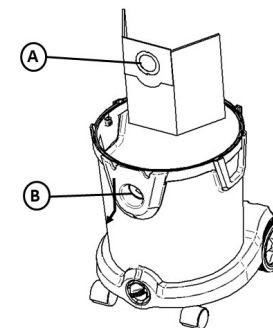

FIG. 8

USAGE

WARNING - To prevent liquid from entering the motor and causing damage, do not operate without filter basket and float. Do not suck up any liquids without a filter or foam filter installed.

WARNING - To reduce the risk of back injury or falls, do not lift full vacuum cleaner. Get assistance or scoop/drain enough contents out to lighten the vacuum cleaner.

Turn on/off by pressing the button (A).

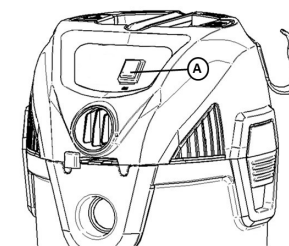

FIG. 9

DRY PICKUP

1. Barrel should be emptied of any wet waste. Filters must be in place.
2. Connect hose and desired attachment.
3. As suction is reduced, stop to clean or replace filters. (Refer to Clean Filters or Filter Installation)
4. After use or when barrel is full, turn off vacuum and disconnect from outlet.
5. Empty barrel and/or remove filter bag. Note: To avoid back strain, do not lift a full barrel/bag.
6. Empty barrel after each use to prevent any type of combustion.

WET PICKUP

1. Vacuum should be emptied of any dry waste. Motor filters may remain in place but if more than one barrel-full of liquid will be collected, use the included wet foam filter.
2. Connect hose and desired attachment.
3. After use or when barrel is full turn off vacuum and disconnect from outlet.
4. Empty barrel after each use by unscrewing drain cap (B). Open vacuum lid and allow to dry thoroughly after wet pickup.

NOTE: When barrel is full the automatic shut-off mechanism will block vacuum pickup, causing the motor to become noticeably high-pitch. Empty barrel to restore suction.

NOTE: Should filter become full of liquid or foam comes out of the exhaust port, drain it by removing filter lock (A) and allowing to drain fully.

NOTE: Do not pick up dry material with a wet filter, drain and dry filter thoroughly or replace with a dry filter.

Filter bag can remain in place when collecting small amounts of water but should be removed when collecting large amounts.

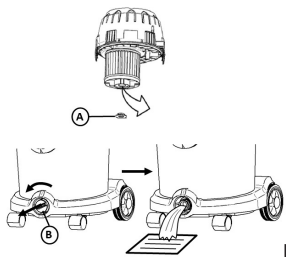

FIG. 10

CLEAN FILTERS (PUSH-TO-CLEAN)

1. If performance decreases, block off hose (A) or inlet port while vacuum is running.
2. Push filter clean button (B) five times.
3. Repeat as necessary.

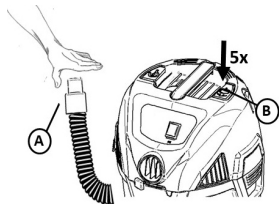

FIG. 11

4. Filter may also be hand washed. Air dry thoroughly before use. **DO NOT USE HEAT.**
5. Filter may also be vacuumed off to restore suction.
6. Proper installation and use of the filter bag will maximize the life of the HEPA filter.

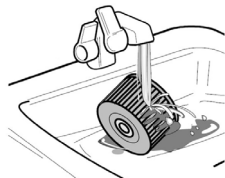

FIG. 12

BLOWER FUNCTION

1. Use the exhaust control lever (B) to direct exhaust air to the blower port.
2. Remove hose from vacuum port and insert into the blower outlet (A).

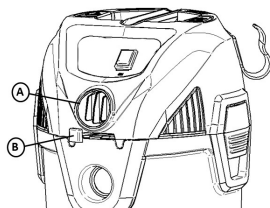

FIG. 13

NOTE: The vacuum could lose suction if tipped over. If this occurs, place vacuum upright again and turn off to allow float to return to its normal position.

NOTE: This vacuum cleaner has a built-in thermal overload protector to protect the motor from overheating, which can occur under heavy use. If the motor shuts off during operation, turn the switch off and allow the motor to cool for 10 minutes. Turn switch on and resume operation.

WAND AND ACCESSORY STORAGE

The tubes can be stored either separately (A) on the back of the machine or together (B) by using the parking hook/function in between use.

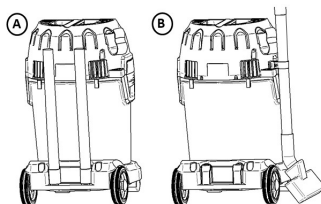

FIG. 14

The accessories can be stored in the accessory holders on the vacuum head.

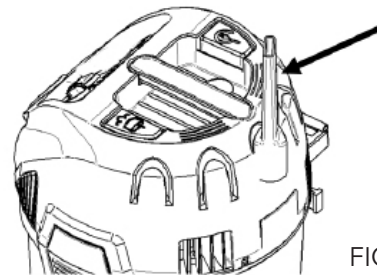

FIG. 15

HOSE AND CORD STORAGE

The cord (A) and hose (B) can be stored in the hooks. These hooks can also be used for storing the hose by coiling it around the machine.

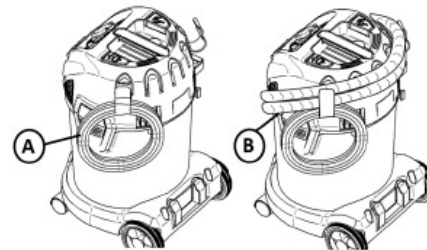

FIG. 16

CONVENIENT TRANSPORT HANDLE

When transporting the vacuum the wands can be put on the handle as shown below.

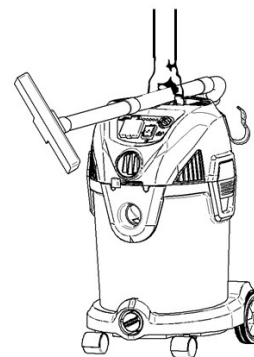

FIG. 17

VOLTS	TOTAL LENGTH OF EXTENSION CORD IN FEET			
	25	50	100	150
120V				
Ampere Rating More Than	AWG			
Not More Than				
0 - 6	18	16	16	14
6 - 10	18	16	14	12
10 - 12	16	16	14	12
12 - 16	14	12	Not Recommended	

NOTE: Static shocks are common in dry areas or when the relative humidity of the air is low. This is only temporary and does not affect the use of the appliance. To reduce the frequency of static shocks in your home, the best remedy is to add moisture to the air with a portable or installed humidifier.

SPECIFICATIONS

Voltage: 120
Amps: 12
Airflow: 138 CFM
Suction: 82.3 in. H₂O
Filtration: HEPA
Filter Clean: Semi-Auto
Cord: 12 ft
Hose: 8 ft, 1.4-inch (35mm) dia.

MAINTENANCE

FILTER REPLACEMENT

1. Remove the filter lock nut (A) and support plate (B).
2. Remove old filter (C).
3. Slide new filter (C) over filter cage (D).
4. Install and secure filter support plate (B) and lock (A).

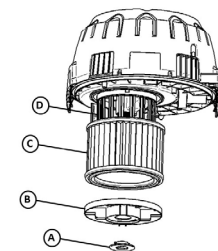

FIG. 18

RECOMMENDED REPLACEMENT INTERVALS

Every 6 months: Replace HEPA Filters

As needed: Replace filter bags

NOTE: In order to prevent unnecessary downtime, it is recommended that you keep the following items in stock:

- 1X HEPA Filters
- 2X Filter Bags
- Motor Brushes

HEPA Wet+Dry Pro

Type: 14-30-PC
 Item no.: D1618
 Serial number:
 Date Produce:
Dustless Technologies
Price, UT 84501

 C MITE US
 11A/120V/60Hz
 Made in PRC



Conforms to UL Std. 1017
 Conforme à la norme 1017 du UL
 Certified to CSA Std. C22.2 No. 243-17
 Certifié pour la norme C22.2 No. 243-17 du CSA

Connect Only To A Dedicated Individual Branch Circuit
 Connexion uniquement à un circuit individuel dédié

TROUBLESHOOTING & FAQ

Repair or service of electrical components such as cord or motor, must only be carried out by an authorized service center.

QUESTION	ANSWER
Vacuum does not start:	<ul style="list-style-type: none"> • Check to see that the plug is correctly inserted in the electrical outlet and that there is power at receptacle. • A circuit breaker may have tripped. Check the circuit breaker box. • The cord or plug may be damaged. Call the Customer Service Department.
Motor stops:	<ul style="list-style-type: none"> • A thermal overload protector will shut off the motor if the motor temperature is too high. If this occurs, turn the switch off. Wait 10 minutes for the motor to cool. Turn switch on and resume operation.
Suction power is reduced:	<ul style="list-style-type: none"> • The tank may be full and needs to be emptied. • The wands, hose, or accessory may be clogged or damaged and need to be cleaned or replaced. • Any of the above may be damaged and need to be replaced. • The filter may be clogged. Use the Filter Cleaning System to clean the filter. • Check the filter and replace it, if necessary. Make sure that is installed properly. • The hose connection is loose. • The drain cap may be open.
Static shocks:	<ul style="list-style-type: none"> • If the environment is too dry, add moisture to air. If possible, use a humidifier. • In case the relative humidity of air is low, please note that this situation will not have any effect on use of the vacuum cleaner.
Will the filter(s) meet current EPA & OSHA guidelines for asbestos and mold removal?	<ul style="list-style-type: none"> • The micro pre-filter bag does not. • The HEPA filter does.

WARRANTY

THREE-YEAR LIMITED WARRANTY

At Dustless Technologies, we stand behind what we build. We warrant this product to the original retail purchaser against defects in materials or workmanship for a period of three years after date of purchase. This limited warranty does not cover claims resulting from: (I) misuse (II) neglect (III) modification (IV) failure to follow instructions.

WARRANTY CARD

Please register your product online at dustlesstools.com within 90 days of purchase.

WARRANTY CLAIMS

For warranty or returns with any of our products, please contact your place of purchase. Technical support is available at (800) 568-3949 or orders@dustlesstools.com.



This brochure was downloaded from

wet-dry-vac.com

The most comprehensive source of information about wet/dry shop vacuums on the Internet!

Wet-dry-vac.com allows you to learn about how to purchase a wet/dry vac, compare and review detailed specifications on hundreds of models, and find compatible filters.

You can also view manuals, parts lists and brochures for hundreds of models. Plus, you can find the best prices for vacuums and filters, and purchase online right from the site.

