

POWERCLEAN™ Drum Vacuum

USER GUIDE
2035 SERIES

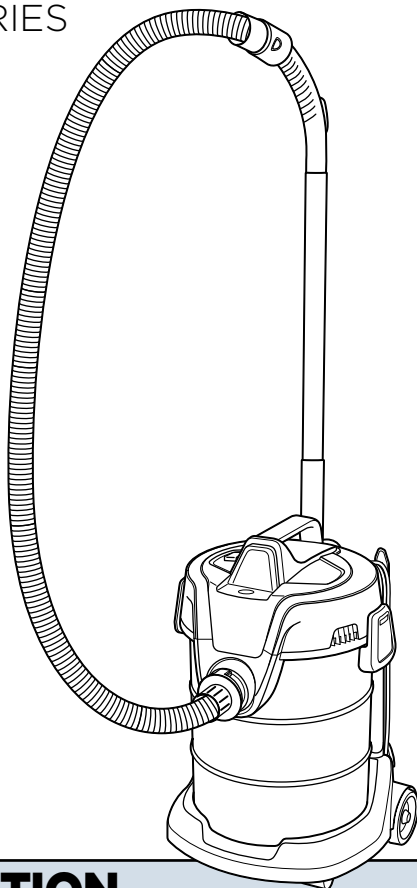

ATTENTION

THE HOSE IS INSIDE THE DRUM. REMOVE THE TOP COVER TO REMOVE.

IMPORTANT SAFETY INSTRUCTIONS

READ ALL INSTRUCTIONS BEFORE USING YOUR CANISTER VACUUM.

Unplug from outlet when not in use and before conducting maintenance. When using an electrical appliance, basic precautions should be observed, including the following:

WARNING

TO REDUCE THE RISK OF FIRE, ELECTRIC SHOCK, OR INJURY:

- » Connect to a properly grounded outlet only. See grounding instructions. Do not modify the 3-prong grounded plug.
- » Do not leave vacuum cleaner when it is plugged in.
- » Unplug from outlet when not in use and before servicing.
- » Do not expose to rain, store indoors.
- » Intended primarily for indoor use and occasional outdoor use.
- » Do not freeze.
- » Do not allow to be used as a toy. Close attention is necessary when used by or near children.
- » Plastic film can be dangerous. To avoid danger of suffocation, keep away from children.
- » Do not use for any purpose other than described in this User's Guide. Use only manufacturer's recommended attachments.
- » Do not plug in your vacuum cleaner until you are familiar with all instructions and operating procedures.
- » To reduce the risk of electrical shock, turn power switch off and disconnect polarized

- plug from electrical outlet before performing maintenance or troubleshooting checks.
- » Do not use with damaged cord or plug. If appliance is not working as it should, has been dropped, damaged, left outdoors, or dropped into water, have it repaired at an authorized service center.
- » Do not pull or carry by cord, use cord as a handle, close a door on cord, or pull cord around sharp edges or corners.
- » Do not run appliance over cord. Keep cord away from heated surfaces.
- » Do not unplug by pulling on cord. To unplug, grasp the plug, not the cord.
- » Do not handle plug or vacuum cleaner with wet hands.
- » Do not put any object into openings. Do not use with any opening blocked; keep openings free of dust, lint, hair, and anything that may reduce air flow.
- » Keep hair, loose clothing, fingers, and all parts of body away from openings and moving parts.
- » Turn off all controls before plugging or unplugging vacuum cleaner.
- » Use extra care when cleaning on stairs.

- » Do not use to pick up flammable or combustible materials (lighter fluid, gasoline, kerosene, etc.) or use in areas where they may be present.
- » Do not use vacuum cleaner in an enclosed space filled with vapors given off by oil base paint, paint thinner, some moth proofing substances, flammable dust, or other explosive or toxic vapors.
- » Do not use to pick up toxic material (chlorine bleach, ammonia, drain cleaner, etc.).
- » Do not pick up anything that is burning or smoking, such as cigarettes, matches, or hot ashes.
- » Do not pick up hard or sharp objects such as glass, nails, screws, coins, etc.
- » Keep appliance on a level surface.
- » Do not carry the appliance while in use.
- » This product should not be used with detergents or to pick up foaming wet messes to prevent internal component damage.
- » Do not immerse. Use only on surfaces moistened by the cleaning process.
- » Do not use without filters in place.
- » Always install float before any wet pick-up operation.

SAVE THESE INSTRUCTIONS FOR FUTURE USE

This model is for household use only. Commercial use of this unit voids the manufacturer's warranty.

WARNING

Improper connection of the equipment-grounding conductor can result in a risk of electrical shock. Check with a qualified electrician or service person if you aren't sure if the outlet is properly grounded. **DO NOT MODIFY THE PLUG.** If it will not fit the outlet, have a proper outlet installed by a qualified electrician. This appliance is designed for use on a nominal 120-volt circuit, and has a grounding attachment plug that looks like the plug in the illustration. Make certain that the appliance is connected to an outlet having the same configuration as the plug. No plug adapter should be used with this appliance.

GROUNDING INSTRUCTIONS

This appliance must be connected to a grounded wiring system. If it should malfunction or break down, grounding provides a safe path of least resistance for electrical current, reducing the risk of electrical shock. The cord for this appliance has an equipment-grounding conductor and a grounding plug. It must only be plugged into an outlet that is properly installed and grounded in accordance with all local codes and ordinances.



Thanks for buying a BISSELL vacuum!

We love to clean and we're excited to share one of our innovative products with you. We want to make sure your vacuum works as well in two years as it does today, so this guide has tips on using (page 7), maintaining (pages 8-9), and if there is a problem, troubleshooting (page 10).

In just a few simple assembly steps, you'll be ready to vacuum. Flip to page 5 and let's get started!

What's In The Box?

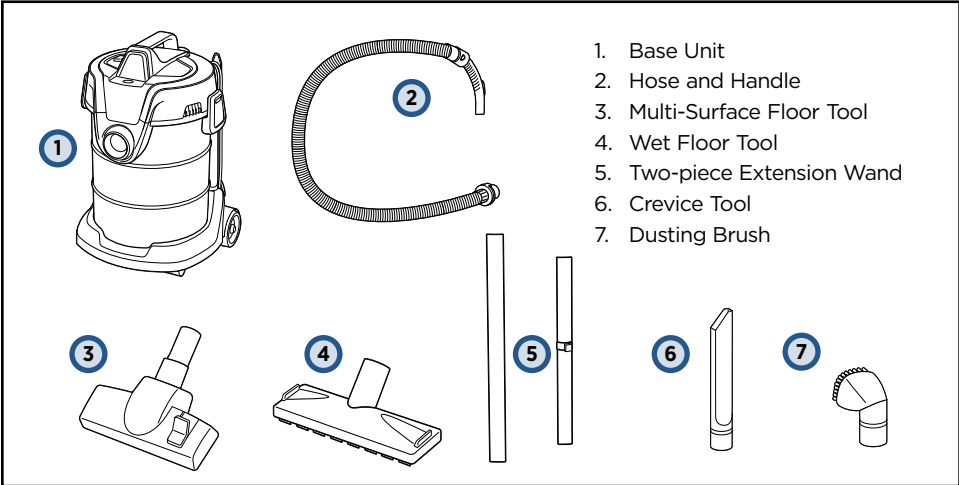

NOTE: Standard accessories may vary by model. To identify what should be included with your purchase, please refer to the "Carton Contents" list located on the carton top flap.

Safety Instructions.....2
Product View.....4
Assembly5-6
Operations7
Maintenance & Care8-9

Troubleshooting10
Warranty.....11
Service.....11
Product Registration.....12
Parts & Supplies12

Product View

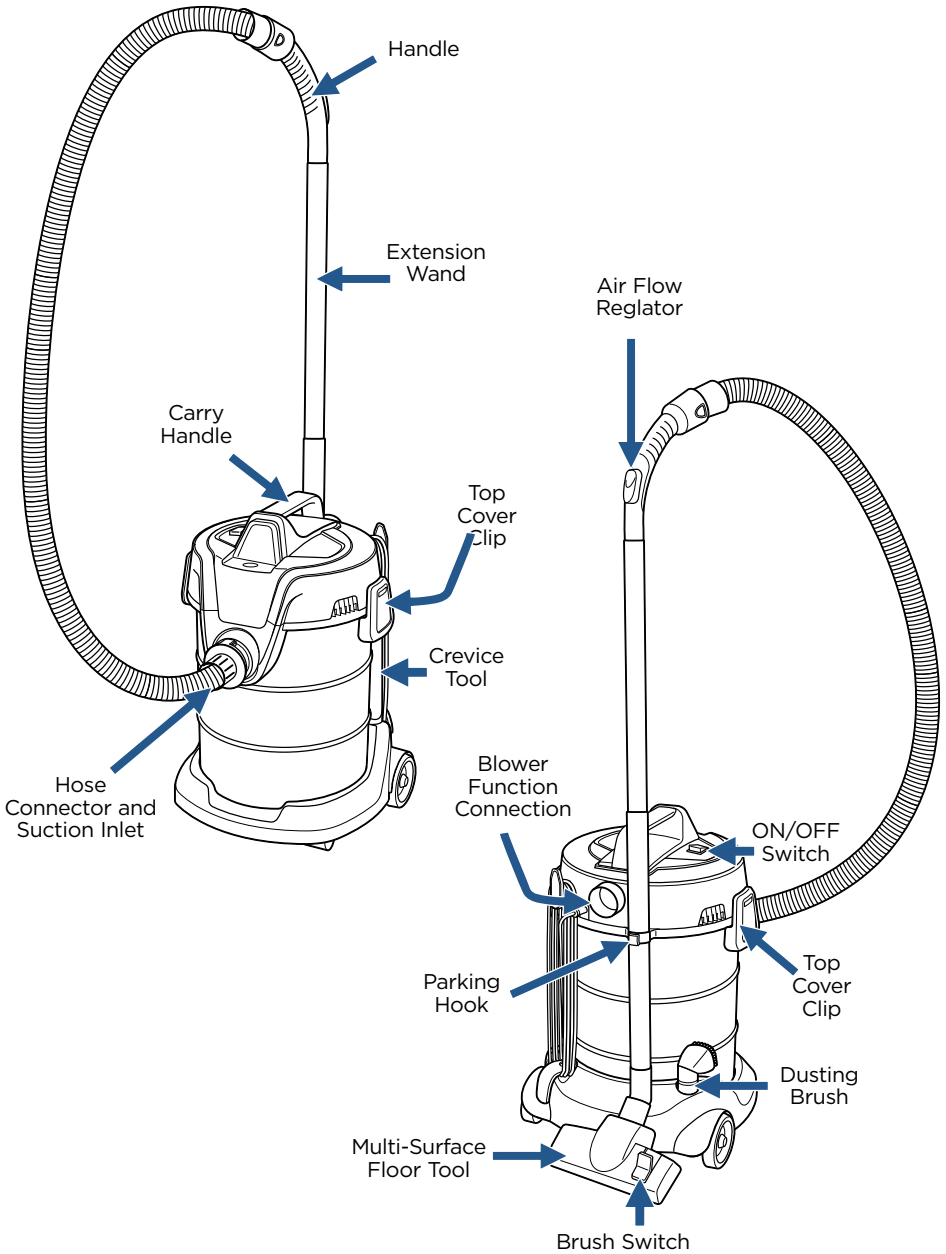

Assembly (Dry Cleaning)

⚠️ WARNING

Do not plug in your vacuum until you are familiar with all instructions and operating procedures.

⚠️ WARNING

Plastic film can be dangerous. To avoid danger of suffocation, keep away from children.

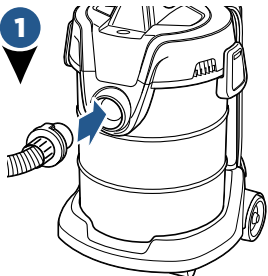

1
Unlock the clips on the Top Cover to remove the Hose. Locate the Hose Connector on end of hose and line up the tab with the arrow on the Suction Inlet. Insert the hose and turn clockwise to secure.

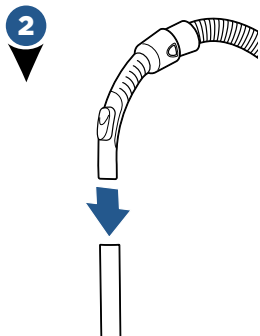

2
Connect Hose Handle to the end of the Extension Wand and twist slightly to tighten.

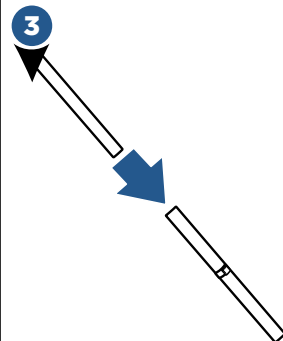

3
Connect Extensions Wands together with the Parking Hook on the lower half.

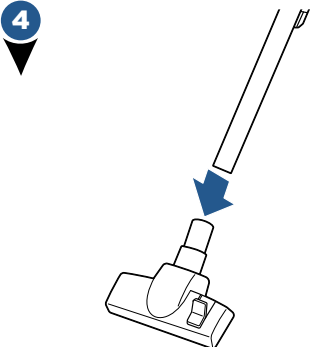

4
Connect the Multi-Surface Floor Tool to end of the Extension Wand and twist slightly to tighten.

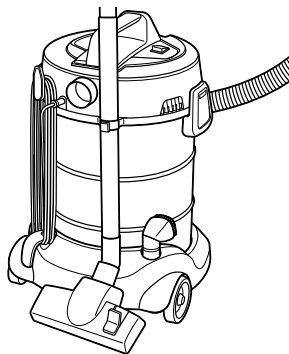

Once assembled, you can store your vacuum by inserting the Parking Hook (located on the Extension Wand) into the storage slot on the rear of the vacuum.

Assembly (Wet Cleaning)

WARNING

Do not plug in your vacuum until you are familiar with all instructions and operating procedures.

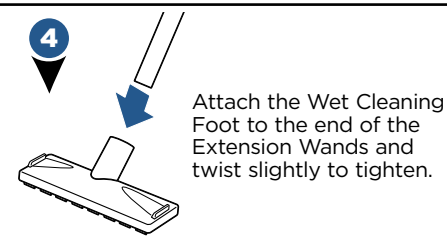
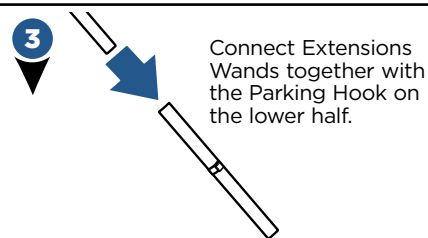
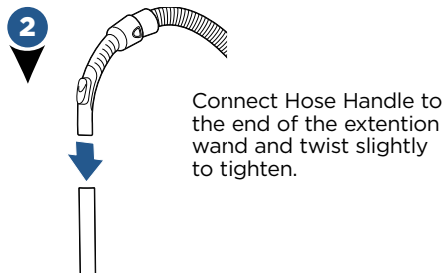
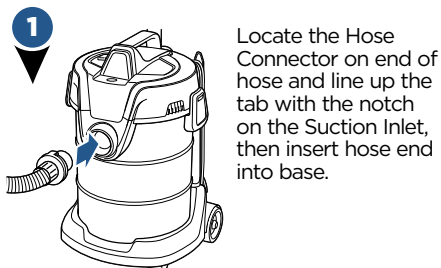

Tools

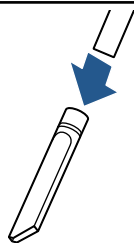

Use the **Crevice Tool** to reach in tight, narrow spaces. The Crevice Tool can also be used to pick up wet messes.



Use the **Dusting Brush** to clean curtains, draperies, and side tables and window ledges.

Parts & Supplies

For Parts and Supplies, go to www.BISSELL.com and enter your model number in the search field.

Operating The Product

⚠️ WARNING

Before using your vacuum, make sure the Dirt Container is in locked position and the filter is in place. **DO NOT** operate your vacuum without a filter.

1

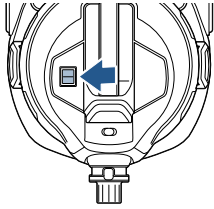

Turn the power ON or OFF by switching the power switch to the ON (I) or OFF (O) position.

2

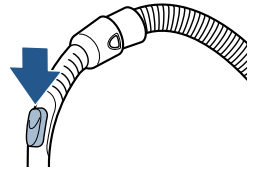

For full suction power, close the Air Flow Regulator by sliding the regulator down to the closed position. Open the Air Flow Regulator to reduce suction power for vacuuming delicate fabrics.

3

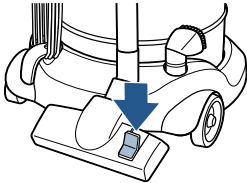

To vacuum carpets and rugs, push the Brush Switch to the carpet position to pull the brushes up into the Floor Nozzle.

4

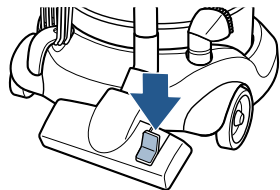

To vacuum bare floors, push the Brush Switch to the bare floor position to extend the brushes down from the Floor Nozzle.

5

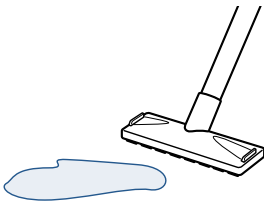

For wet cleaning, use the Wet Cleaning Foot to vacuum up spills.

6

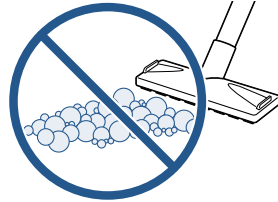

This product should not be used with detergents or to pick up foaming wet messes.

7



For above floor cleaning, disconnect the floor tool from the end of the Extension Wand and attach desired accessory.

8

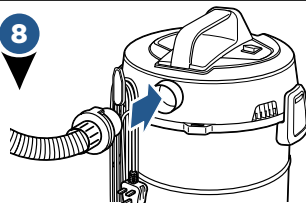

To use the Blower function, insert the hose with the notch facing upward and twist clockwise to lock in place.

Emptying the Dirt Container

WARNING

To reduce the risk of electrical shock, turn power switch OFF and disconnect polarized plug from electrical outlet before performing maintenance or troubleshooting checks.

1

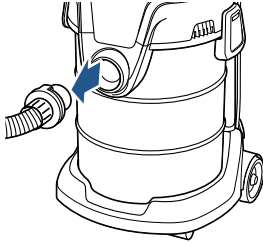

Unplug the vacuum from the electrical outlet and disconnect the Hose.

2

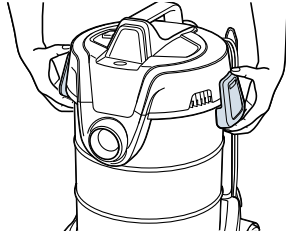

Undo the clips on both sides of the Top Cover and lift up to remove.

3



Remove the Large Fabric Filter by pulling up holding both sides and then setting it to the side.

4

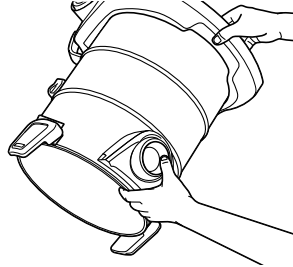

Hold the unit by the base and handle and tip dirt out into a trash can for dry messes and outside or in a sink for wet messes.

NOTE: If you suffer from allergies, place a plastic bag over top of Dirt Container and tip upside down to empty. Wait for dust to settle, remove bag and discard.

5

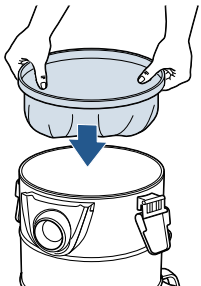

Return filter, ensuring its seal covers the top of the wall of the Dirt Container all the way around.

6

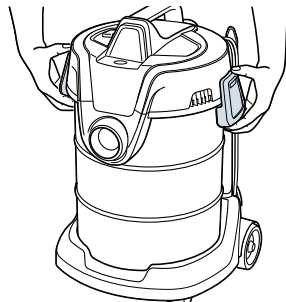

Replace vacuum Top Cover and close clips.

Cleaning the Filters

⚠️ WARNING

To reduce the risk of electrical shock, turn power switch OFF and disconnect polarized plug from electrical outlet before performing maintenance or troubleshooting checks.

⚠️ WARNING

Do not operate vacuum with a damp or wet filter, or without filter or the Dirt Container in place. Allow components to dry before reassembling the Dirt Container.

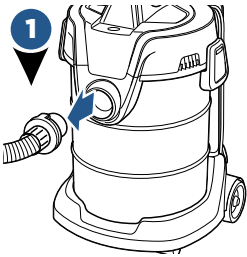

1
Unplug the vacuum from the electrical outlet and disconnect the Hose.

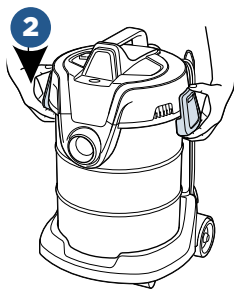

2
Undo the clips on both sides of the Top Cover.

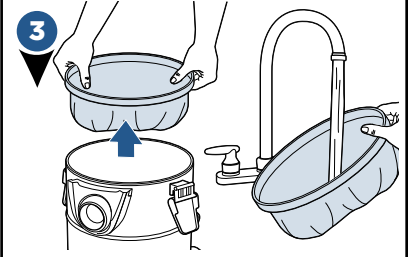

3
Remove the Large Fabric Filter and hand wash in cold water with mild detergent. Rinse well and air dry for 24 hours.

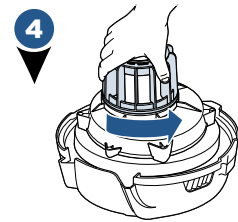

4
Remove the Top Cover of drum vacuum and grasp the plastic Filter Cage, turning counter-clockwise to unlock.

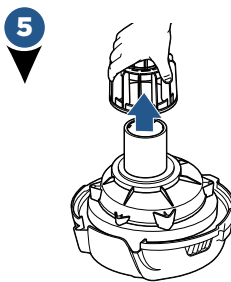

5
Then pull up to remove.

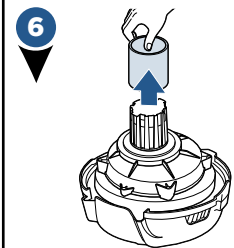

6
Remove the Foam Filter and rinse to clean. Allow the filter to fully dry before reinstalling.

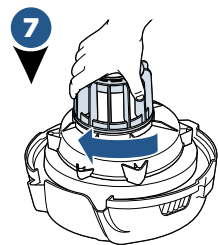

7
Once completely dry, return Filter to the Dirt Container. Ensure the Filter basket is installed and surrounding entire tank wall. Turn clockwise to seal.

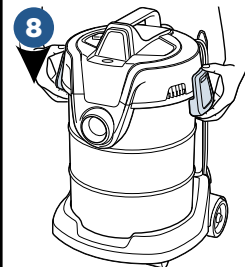

8
Return the dry Large Fabric Filter, place vacuum Top Cover and close clips.

Troubleshooting

WARNING

To reduce the risk of electric shock, turn power switch OFF and disconnect plug from electrical outlet before performing maintenance or troubleshooting checks.

Problem	Possible causes	Remedies
Vacuum won't pick up dirt	Filter is dirty.	Remove and rinse Filter. Allow enough time to dry properly before reinserting.
	Main Hose is not connected.	Reconnect the main Hose by pushing the hose connection to secure latch.
	Crack or hole in the main Hose.	If there is a crack or hole, order a new hose from www.BISSELL.com .
	Clog in the Floor Tool.	Remove debris and any other entanglements that may be restricting its rotation.
	Clog in the Filter.	Remove the Dirt Container Filter assembly and tap it over a rubbish bin to remove any dirt or debris from the cyclone screen that surrounds the filter.
	Clog in the vacuum.	Check to see if there are any clogs in the Suction Inlet.
	Filter is not seated correctly.	Ensure the Filter black portion of the filter is completely on the lip of the metal drum.
Dirt is escaping from the vacuum	Dirt Container is full.	Empty the Dirt Container.
	Filter is missing.	Check to see if Filter is in place.
	Filter is not seated properly.	Ensure the Filter basket is sitting completely on the wall of the Dirt Container all the way around.

Please do not return this product to the store.

Other maintenance or service not included in the manual should be performed by an authorized service representative.

For any questions or concerns, BISSELL is happy to be of service. Contact us directly at 1-800-237-7691.

Warranty

This warranty gives you specific legal rights, and you may also have other rights which may vary from state to state. If you need additional instruction regarding this warranty or have questions regarding what it may cover, please contact BISSELL Consumer Care by E-mail or telephone as described below.

Limited Two-Year Warranty

Subject to the *EXCEPTIONS AND EXCLUSIONS identified below, upon receipt of the product BISSELL will repair or replace (with new, refurbished, lightly used, or remanufactured components or products), at BISSELL's option, free of charge from the date of purchase by the original purchaser, for two years, any defective or malfunctioning part.

See information below on "If your BISSELL product should require service."

This warranty applies to product used for personal, and not commercial or rental, service. This warranty does not apply to fans or routine maintenance components such as filters, belts, or brushes. Damage or malfunction caused by negligence, abuse, neglect, unauthorized repair, or any other use not in accordance with the User's Guide is not covered. This warranty will only be

vaTop Cover if the product is used in the same country in which it was sold.

BISSELL IS NOT LIABLE FOR INCIDENTAL OR CONSEQUENTIAL DAMAGES OF ANY NATURE ASSOCIATED WITH THE USE OF THIS PRODUCT. BISSELL'S LIABILITY WILL NOT EXCEED THE PURCHASE PRICE OF THE PRODUCT.

Some states do not allow the exclusion or limitation of incidental or consequential damages, so the above limitation or exclusion may not apply to you.

***EXCEPTIONS AND EXCLUSIONS FROM THE TERMS OF THE LIMITED WARRANTY**
THIS WARRANTY IS EXCLUSIVE AND IN LIEU OF ANY OTHER WARRANTIES EITHER ORAL OR WRITTEN. ANY IMPLIED WARRANTIES WHICH MAY ARISE BY OPERATION OF LAW, INCLUDING THE IMPLIED WARRANTIES OF MERCHANTABILITY AND FITNESS FOR A PARTICULAR PURPOSE, ARE LIMITED TO THE TWO-YEAR DURATION FROM THE DATE OF PURCHASE AS DESCRIBED ABOVE.

Some states do not allow limitations on how long an implied warranty lasts, so the above limitation may not apply to you.

NOTE: Please keep your original sales receipt. It provides proof of date of purchase in the event of a warranty claim.

Service

If your BISSELL product should require service:

Contact BISSELL Consumer Care to locate a BISSELL Authorized Service Center in your area.

If you need information about repairs or replacement parts, or if you have questions about your warranty, contact BISSELL Consumer Care.

Website:

www.BISSELL.com/service-centers

E-mail:

www.BISSELL.com/email-us

Call:

BISSELL Consumer Care
1-800-237-7691

Monday - Friday 8am - 10pm ET

Saturday 9am - 8pm ET

Sunday 10am - 7pm ET

Register your product today!

Registering is quick, easy, and offers you benefits over the lifetime of your product.

You'll receive:

BISSELL Rewards Points

Automatically earn points for discounts and free shipping on future purchases.

Faster Service

Supplying your information now saves you time should you need to contact us with questions regarding your product.

Product Support Reminders and Alerts

We'll contact you with any important product maintenance reminders and alerts.

Special Promotions

Optional: Register your email to receive notice of offers, contests, cleaning tips, and more!

Visit www.BISSELL.com/registration!

Visit the BISSELL website: www.BISSELL.com

When contacting BISSELL, have model number of cleaner available.

Please record your Model Number: _____

Please record your Purchase Date: _____

NOTE: Please keep your original sales receipt. It provides proof of purchase date in the event of a warranty claim. See the Warranty page for details.

Parts & Supplies

For Parts and Supplies, go to www.BISSELL.com and enter your model number in the search field.

We can't wait to hear from you!

Rate this product and let us (and millions of your closest friends) know what you think!

www.BISSELL.com



©2018 BISSELL Homecare, Inc.
Grand Rapids, Michigan
All rights reserved. Printed in China
Part Number 161-5458 04/18
Visit our website at: www.BISSELL.com

This manual was downloaded from

wet-dry-vac.com

The most comprehensive source of information about wet/dry shop vacuums on the Internet!

Wet-dry-vac.com allows you to learn about how to purchase a wet/dry vac, compare and review detailed specifications on hundreds of models, and find compatible filters.

You can also view manuals, parts lists and brochures for hundreds of models. Plus, you can find the best prices for vacuums and filters, and purchase online right from the site.

